



Scoring & Timing Solution for Squash



THE PENINSULA
SHANGHAI

PSA
WORLD TOUR

0 6 - 8 - 0

DONGJIN WELLY

PSA
WORLD TOUR

1. Introduction

This is a professional solution for LED scoreboard display in Squash stadiums.

Mainly for large-scale Squash matches which held in professional sports venues.

The system functions conform to WSF rules.

Match arrangement, real-time scoring & timing display, players' & referees' info display, rank statistics export & print, and advertising display can be realized through the coordination of Match Scoring System, Meet Management System, etc.

It is an ideal choice for most of smart and professional stadiums.

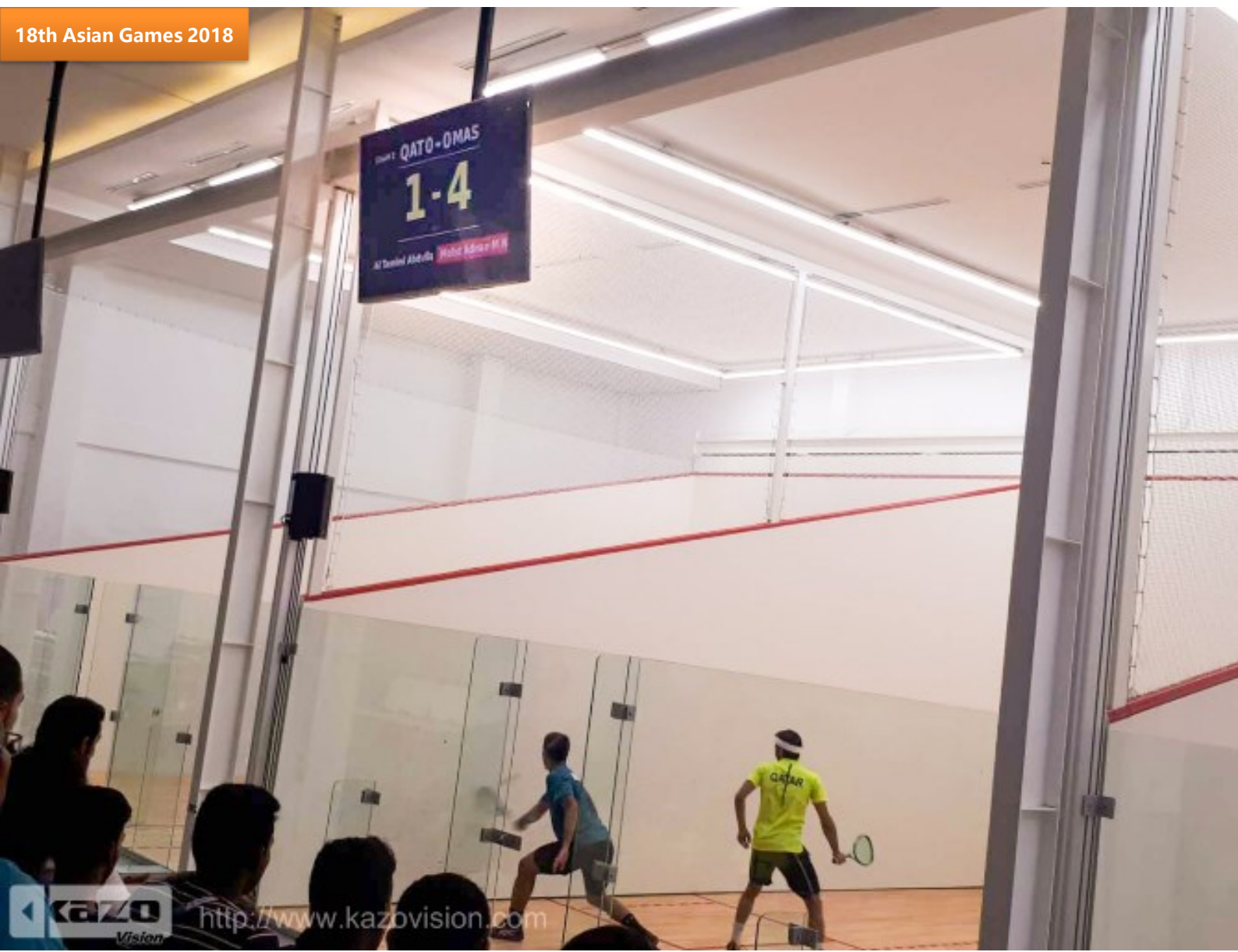

1.1 System Architecture

The whole system is composed of several subsystems, including: Match Scoring System and Meet Management System.

Each subsystem can not only work independently, but also work together to share the data.

It is flexible for customers to configure according to the actual application.

- **Match Scoring System**

Match Scoring System named ULTRA SCORE is composed of Ultra Score Software, Wireless Score Tablet, etc.

It is mainly operated by the referees to realize the scoring and timing work and real-time scoreboard display.

The system functions conform to WSF rules.

- **Meet Management System**

It is composed of Meet Management Server, On-Venue Results Workstation, Printer, etc.

Linking with Online Registration System and Match Scoring System, it can realize: participants management, match schedule, result management, technical statistics, court arrangement, rank statistics, etc.

1.2 System Chart

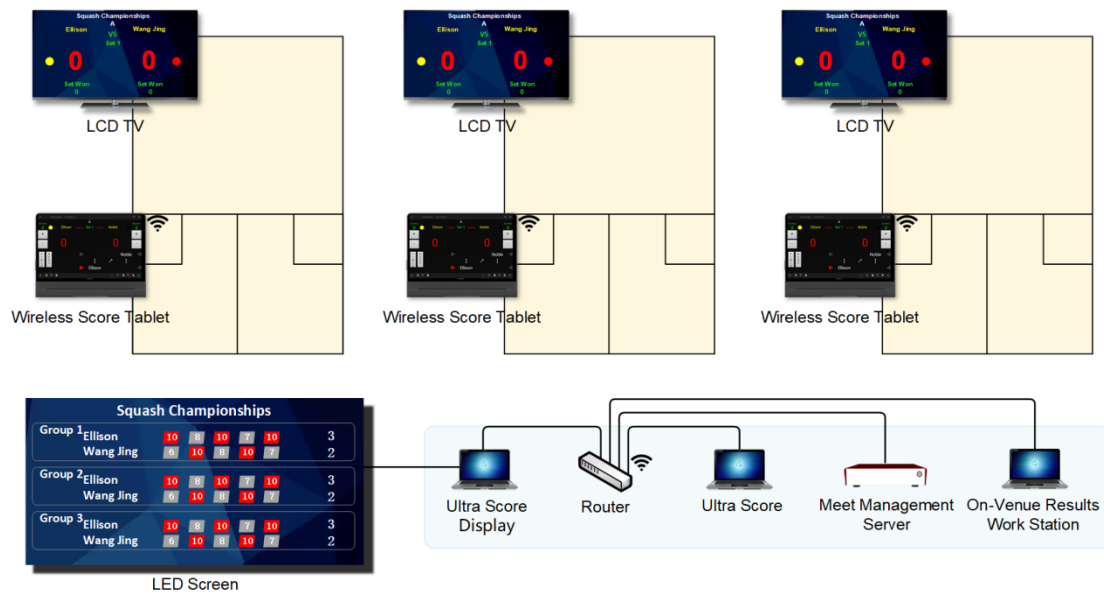

System Description

1. The system has the functions of scoring, timing and displaying in the court.
2. It supports tournament schedule and result exporting.
3. It also has lots of multi-media functions which can switch between scores and advertisements display.
4. One set of wireless tablet, score display software and LED monitor shall be equipped to manage and display the information of the score, players and sets.
5. The score information of the court will be gathered to display on the LED screen at the same time.

1.3 Product Configuration

Product	Type	Qt.
Ultra Score Software	Standard Network Edition	1
Score Tablet	KS-GC14-I11	1
Score Display Software	ULTRASCORE VIEWER	1
LCD Display	48inch LCD	1
Meet Management Server	KS-MMS-MINI	1
Router	D-Link	1
PC	Dell	2

2. Specification for products

2.1 Ultra Score Software

Products	Details
Standalone edition	<ul style="list-style-type: none">◆ Installed on one PC.◆ Supports: Squash◆ English version◆ Including 1 dongle
Standard network edition	<ul style="list-style-type: none">◆ Terminal + 1 Display◆ Supports: Squash◆ English version◆ Including 1 dongle
Professional network edition	<ul style="list-style-type: none">◆ Terminal + Referee + 2 Display◆ Supports: Squash◆ English version◆ Including 1 dongle

Difference:

Standalone Edition:

Match management, Scoring, and Media display functions, all in one installed on a PC. Referee must do operation on the PC for display directly.

It is suitable for the stadium where has just one screen, which doesn't have strict needs of the scoring and timing accuracy.

Standard Network Edition:

Score terminal and media player functions can be installed on 2 PCs respectively. So that one independent PC can be setup on the courtside special for referee's operation, the other PC running as media player to manage the LED display.

It is suitable for the stadium where has one screen, needs to do the scoring and timing on the courtside.

Professional Network Edition:

Except the function of score terminal, 1-3 media players can be equipped on PCs separately, in order to display different contents on several LED screens.

It is suitable for the stadium where has more than 2 screens where referee need to do scoring on the courtside and LED screens need to display different contents separately. (For example, one LED screen is for scoreboard and another is for advertising or player info).

Squash display interface



2.2 Wireless Score Tablet

Products	Details
<p>Wireless Score Controller Tablet</p>	<p>Type: KS-GC14-111</p> <ul style="list-style-type: none"> ◆ Screen: 11"inch ◆ Pixel: 1920*1200IPS ◆ Ram: 6GB ◆ Storage: 128GB ◆ Battery: 8000mAh ◆ System: Android ◆ Supports: Squash ◆ Communication: WIFI ◆ Full colored touch screen

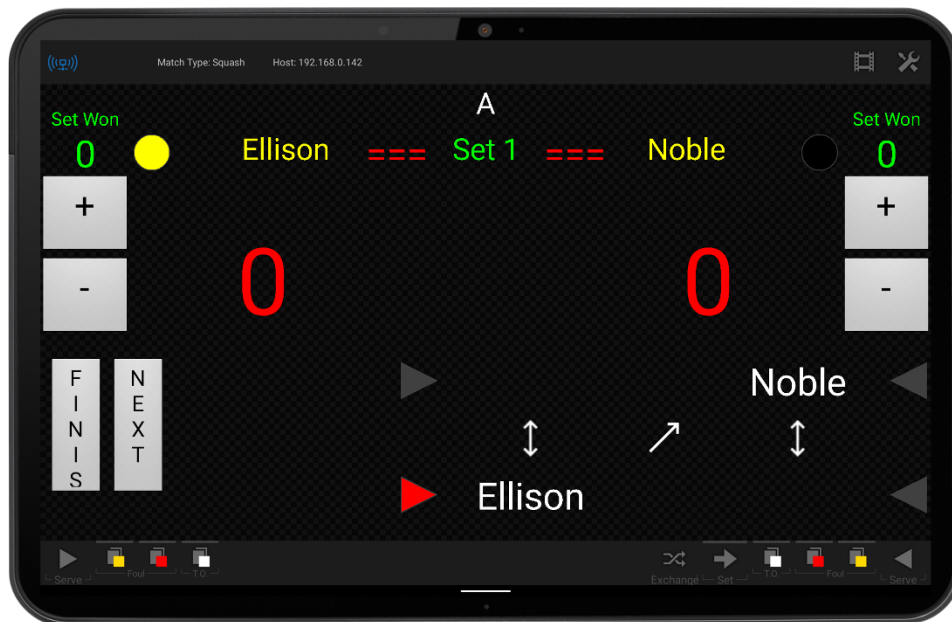

2.3 Score Display Software

Products	Details
Score Display Software	<p>Type: ULTRASCORE VIEWER</p> <ul style="list-style-type: none"> ◆ In multi-court mode, used to display the information of the score, players and set for each court. ◆ Output score display to one LCD monitor. ◆ Screen will be updated in real time based on the referee's operation.

Display interface

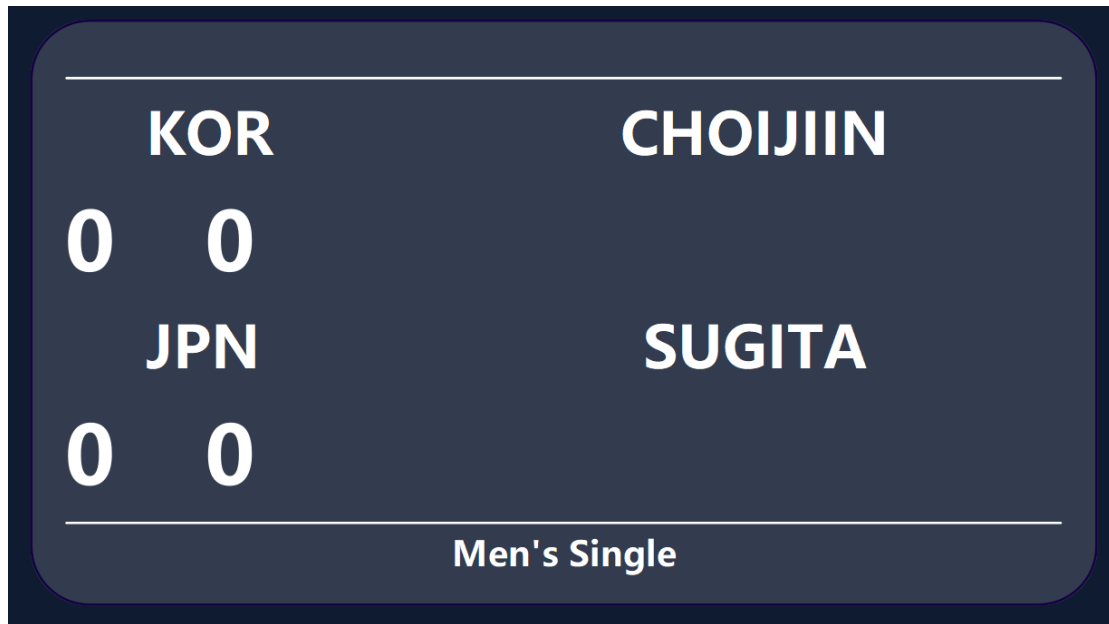

2.4 Meet Management Server

Products	Details
Meet Management Server	<p>Type: S-MMS-MINI Size: 260*135*35 (mm) Weight: 1.0 KG Input Voltage: 12V DC RAM: 4GB CPU: Intel J3160 Hard Disk: 64G Communication: LAN*1 Port: VGA*1, DP*1, USB*2</p> <p>Features:</p> <ul style="list-style-type: none">● Multi-court arrangement, auto generate the order form.● Multi-project arrangement, make the schedule more smoothly.● Monitor the status of each court in real time, including the current field, rotation and player info.● Court adjustment, can manually modify the match court and session info.● Summary and print integrated report.

